

Drain: SPRINGMILL VILLAGES DRAIN **Drain #:** 268
Improvement/Arm: THE MEADOWS - SECTION 2
Operator: JOH **Date:** 5-18-04
Drain Classification: Urban/Rural **Year Installed:** 1995

GIS Drain Input Checklist

- Pull Source Documents for Scanning JOH
- Digitize & Attribute Tile Drains N/A
- Digitize & Attribute Storm Drains JOH
- Digitize & Attribute SSD JOH
- Digitize & Attribute Open Ditch N/A
- Stamp Plans JOH
- Sum drain lengths & Validate JOH
- Enter Improvements into Posse JOH
- Enter Drain Age into Posse JOH
- Sum drain length for Watershed in Posse JOH
- Check Database entries for errors JOH

Gasb 34 Footages for Historical Cost Drain Length Log

Drain-Improvement: SPRINGMILL VILLAGES DRAIN-THE MEADOWS-SECTION 2

Drain Type:	Size:	Length <small>SURVEYORS REPORT</small>	Length (DB Query)	Length Reconcile	Price:	Cost:
SSO	6"	4814	4814	Ø	\$2.00	9,628.00
RCP	12"	319'	319'	Ø	7.25	2,312.75
	15"	835'	835'	Ø	9.50	7,932.50
	24"	619'	619'	Ø	18.00	11,142.00
	30"	440'	440'	Ø	24.60	10,824.00
	33"	163'	163'	Ø	28.50	4,645.50
	36"	378'	498'	+120'	32.25	16,060.50
	42"	696'	696'	Ø	52.65	36,644.40

Sum: 8,264' 8,384' +120 \$99,189.65

Final Report: _____

Comments:
SR AND AS DISAGREE ON 36" RCP LENGTHS

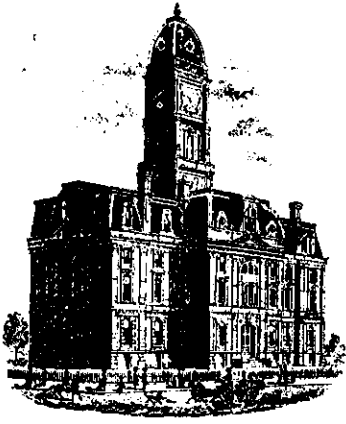

SURVEYOR'S OFFICE

Hamilton County

Kenton C. Ward, Surveyor

Suite 146

776-8495

One Hamilton County Square

Noblesville, Indiana 46060-2230

December 20, 1994

TO: Hamilton County Drainage Board

RE: Springmill Village Drain-Section 2, The Meadows

Attached is a petition, non-enforcement request, plans, calculations, quantity summary and assessment roll for the The Meadows, Section 2 Arm of the Springmill Village Drain. I have reviewed the submittals and petition and have found each to be in proper form.

I have made a personal inspection of the land described in the petition. Upon doing so, I believe that the drain is practicable; will improve the public health; benefit a public highway and be of public utility; and that the costs, damages and expenses of the proposed drain will probably be less than the benefits accruing to the owners of land likely to be benefited. The drain will consist of the following:

6" SSD	4450 feet	30" RCP	440 feet
12" RCP	318 feet	33" RCP	164 feet
15" RCP	844 feet	36" RCP	381 feet
24" RCP	627 feet	42" RCP	689 feet

The total length of the drain will be 7,913 feet.

The retention pond (lake) located in Block B is not to be considered part of the regulated drain. Only the inlet and outlet will be maintained as part of the regulated drain. The maintenance of the pond (lake) will be the responsibility of the Homeowners Association. The Board will however, retain jurisdiction for ensuring the storage volume for which the lake was designed will be retained. Thereby, allowing no fill or easement encroachments.

The subsurface drains (SSD) to be part of the regulated drain are those located under the curbs and those main lines between lots or in rear yards. Only the main SSD lines which are located within the easement/right of way are to be maintained as regulated drain. Laterals for individual lots will not be considered part of the regulated drain.

I have reviewed the plans and believe the drain will benefit each lot equally. Therefore, I recommend each lot be assessed equally. I also believe that no damages will result to landowners by the construction of this drain. I recommend a maintenance assessment of \$30.00 per lot, \$5.00 per acre for roadways, with a \$30.00 minimum. With this assessment the total annual assessment for this section will be \$ *1,568.30*

Parcels assessed for this drain may be assessed for the Overman-Harvey and/or ~~Villages Farms~~ Drains at sometime in the future.

I believe this proposed drain meets the requirements for Urban Drain Classification as set out in IC 36-9-27-67 to 69. Therefore, this drain shall be designated as an Urban Drain.

I recommend that upon approval of the above proposed drain that the Board also approve the attached non-enforcement request. This request is for the reduction of the regulated drain easement to those easement widths as shown on the secondary plat for The Meadows at Springmill Village, Section 2, as recorded in the office of the Hamilton County Recorder.

I recommend the Board set a hearing for this proposed drain for February 1995.

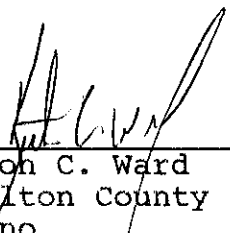

Kenton C. Ward
Hamilton County Surveyor
KCW/no

CERTIFICATE OF COMPLETION AND COMPLIANCE

TO: HAMILTON COUNTY SURVEYOR

RE: The Meadows at Springmill Villages Section 2

I hereby certify that:

- 1.) I am a Registered Engineer in the State of Indiana,
- 2.) I am familiar with the plans and specifications for the above referenced subdivision,
- 3.) I have personally observed and supervised the completion of the Drainage Facilities for the above referenced subdivision, and
- 4.) To the best of my knowledge, information and belief, the Drainage Facilities within the subdivision has been installed and completed in conformity with all plans and specifications.

Signature: _____

Duane A. Sharrer

Date: _____

11/30/94

Type or Printed Name: Duane A. Sharrer

Business Address: 3020 N. Post Road Indianapolis, IN 46226

Telephone: 317-898-8282

INDIANA REGISTRATION NUMBER

890258

SEAL



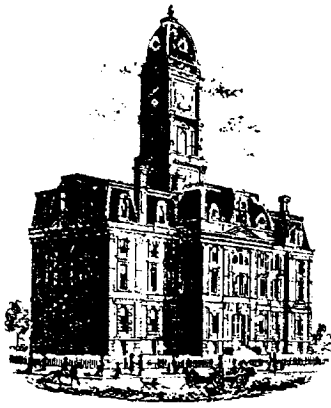

SURVEYOR'S OFFICE

Hamilton County

Kenton C. Ward, CFM
 Surveyor of Hamilton County
 Phone (317) 776-8495
 Fax (317) 776-9628

Suite 188
 One Hamilton County Square
 Noblesville, Indiana 46060-2230

To: Hamilton County Drainage Board

December 5, 2008

Re: Springmill Villages: The Meadows Sec.2 (Revised Final Report)

Attached are as-builts, certificate of completion & compliance, and other information for The Meadows Section 2. An inspection of the drainage facilities for this section has been made and the facilities were found to be complete and acceptable.

During construction, changes were made to the drain which will alter the plans submitted with my report for this drain dated December 20, 1994. The changes are as follows:

STR 170-172	42" RCP	lengthened form 132' feet to 133' feet.
STR 173-174	42" RCP	shortened from 28' feet to 26' feet.
STR 174-175	42" RCP	lengthened from 307' feet to 308' feet.
STR 175-176	36" RCP	shortened from 39' feet to 38' feet.
STR 176-177	36" RCP	shortened from 304' feet to 303' feet.
STR 177-178	36" RCP	shortened from 38' feet to 36' feet.
STR 178-179	36" RCP	lengthened from 120' feet to 121' feet.
This structure was missed on the original report.		
STR 179-180	33" RCP	shortened from 164' feet to ^{163'} 164' feet.
STR 180-181	30" RCP	lengthened from 220' feet to 222' feet.
STR 181-End Section	30" RCP	shortened from 220' feet to 218' feet.
STR 210-155	15" RCP	shortened from 128' feet to 125' feet.
STR 191-190	12" RCP	lengthened from 128' feet to 129' feet.
STR 189-188	15" RCP	shortened from 28' feet to 26' feet.
STR 188-187	24" RCP	lengthened from 165' feet to 166' feet.
STR 195-194	12" RCP	shortened from 123' feet to 122' feet.
STR 194-193	12" RCP	lengthened from 35' feet to 36' feet.
STR 193-192	15" RCP	shortened from 28' feet to 26' feet.
STR 192-175	15" RCP	lengthened from 228' feet to 230' feet.
STR 196-197	24" RCP	shortened from 179' feet to 75' ^{75'} feet. 175'
STR 197-198	24" RCP	shortened from 28' feet to 26' feet.
STR 198-199	24" RCP	lengthened from 18' feet to 19' feet.
STR 199-200	24" RCP	shortened from 170' feet to 166' feet.
STR 171-171A	15" RCP	shortened from 232' feet to 230' feet.
STR 171A-170	15" RCP	shortened form 200' feet to 198' feet.

Springmill Villages Drain, The Meadows Sec. 2 Arm, May 9, 1996, Page 2

STR 169-168 42" RCP lengthened from 42' feet to 49' feet.
The correct total of 6" SSD is 4814 feet.

The length of the drain due to the changes described above is now ^{8264'}~~8384~~ feet.

The non-enforcement was approved by the Board at its meeting on February 27, 1995.

Springmill Villages The Meadows was not bonded.

It has recently been discovered that the offsite storm constructed for this section was never picked up as regulated drain in sections 3A, 3B, or 4A of the Meadows as I had originally intended. Therefore, this final report will be amended to reflect the 8264 feet of storm mentioned above along with the 1738 feet of 36" RCP constructed with the offsite storm facilities. These facilities begin at Str. OS 1 to Str. OS6. Therefore the total length of drain for The Meadows at Springmill Villages Section 2 will be 10,002 feet.

This report is a revision to my original final report dated May 9, 1996 (DRB 4 pg. 235). I recommend the Board approve the drain's construction as complete and acceptable.

Sincerely,

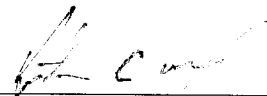

Kenton C. Ward, CFM
Hamilton County Surveyor

KCW/slm

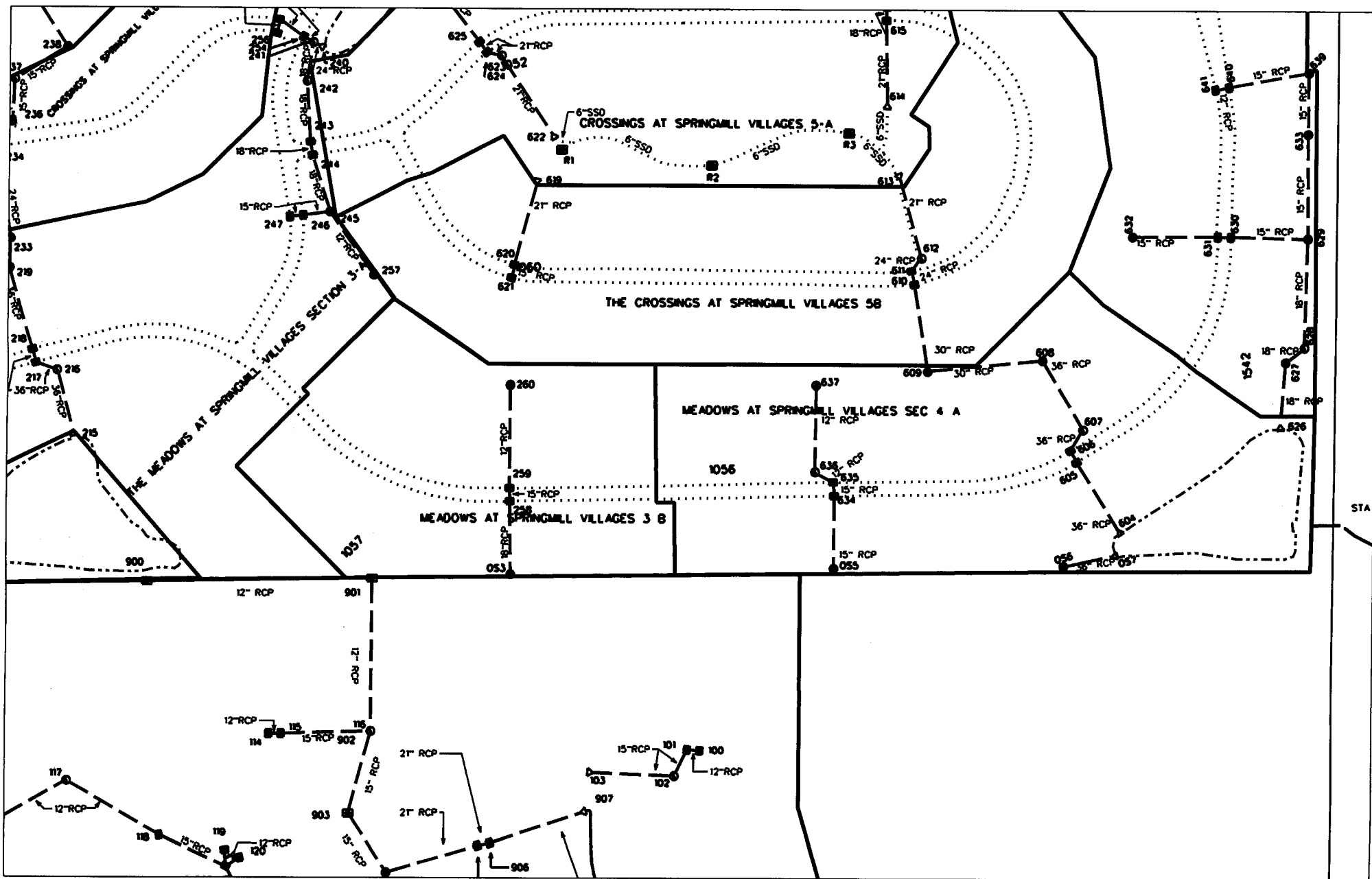

sub_rg_drm.dgn 12/5/2008 4:08:43 PM



SURVEYOR'S OFFICE

Hamilton County

Kenton C. Ward, Surveyor

Phone (317) 776-8495

Fax (317) 776-9628

Suite 146
One Hamilton County Square
Noblesville, Indiana 46060-2230

May 9, 1996

To: Hamilton County Drainage Board

Re: Springmill Villages Drain
The Meadows Section 2 Arm

Attached are as-builts, certificate of completion & compliance, and other information for The Meadows Section 2. An inspection of the drainage facilities for this section has been made and the facilities were found to be complete and acceptable.

During construction, changes were made to the drain which will alter the plans submitted with my report for this drain dated December 20, 1994. The changes are as follows:

STR 170-172	42" RCP	lengthened from 132' feet to 133' feet.
STR 173-174	42" RCP	shortened from 28' feet to 26' feet.
STR 174-175	42" RCP	lengthened from 307' feet to 308' feet.
STR 175-176	36" RCP	shortened from 39' feet to 38' feet.
STR 176-177	36" RCP	shortened from 304' feet to 303' feet.
STR 177-178	36" RCP	shortened from 38' feet to 36' feet.
STR 178-179	36" RCP	lengthened from 120' feet to 121' feet.

This structure was missed on the original report.

STR 179-180	33" RCP	shortened from 164' feet to ^{163'} 164' feet.
STR 180-181	30" RCP	lengthened from 220' feet to 222' feet.
STR 181-End Section	30" RCP	shortened from 220' feet to 218' feet.
STR 210-155	15" RCP	shortened from 128' feet to 125' feet.
STR 191-190	12" RCP	lengthened from 128' feet to 129' feet.
STR 189-188	15" RCP	shortened from 28' feet to 26' feet.
STR 188-187	24" RCP	lengthened from 165' feet to 166' feet.
STR 195-194	12" RCP	shortened from 123' feet to 122' feet.
STR 194-193	12" RCP	lengthened from 35' feet to 36' feet.
STR 193-192	15" RCP	shortened from 28' feet to 26' feet.
STR 192-175	15" RCP	lengthened from 228' feet to 230' feet.
STR 196-197	24" RCP	shortened from 179' feet to ^{178'} 179' feet.
STR 197-198	24" RCP	shortened from 28' feet to 26' feet.
STR 198-199	24" RCP	lengthened from 18' feet to 19' feet.
STR 199-200	24" RCP	shortened from 170' feet to 166' feet.
STR 171-171A	15" RCP	shortened from 232' feet to 230' feet.
STR 171A-170	15" RCP	shortened from 200' feet to 198' feet.

Springmill Villages Drain, The Meadows Sec. 2 Arm, May 9, 1996, Page 2

STR 169-168 42" RCP lengthened from 42' feet to 49' feet.
The correct total of 6" SSD is 4814 feet.

The length of the drain due to the changes described above is now ^{8204'}~~8384~~ feet.

The non-enforcement was approved by the Board at its meeting on February 27, 1995.

Springmill Villages The Meadows was not bonded.

I recommend the Board approve the drains construction as complete and acceptable.

Sincerely,

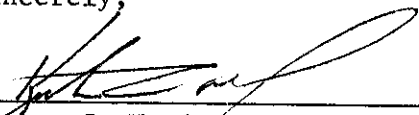

Kenton C. Ward
Hamilton County Surveyor

KCW/ndw

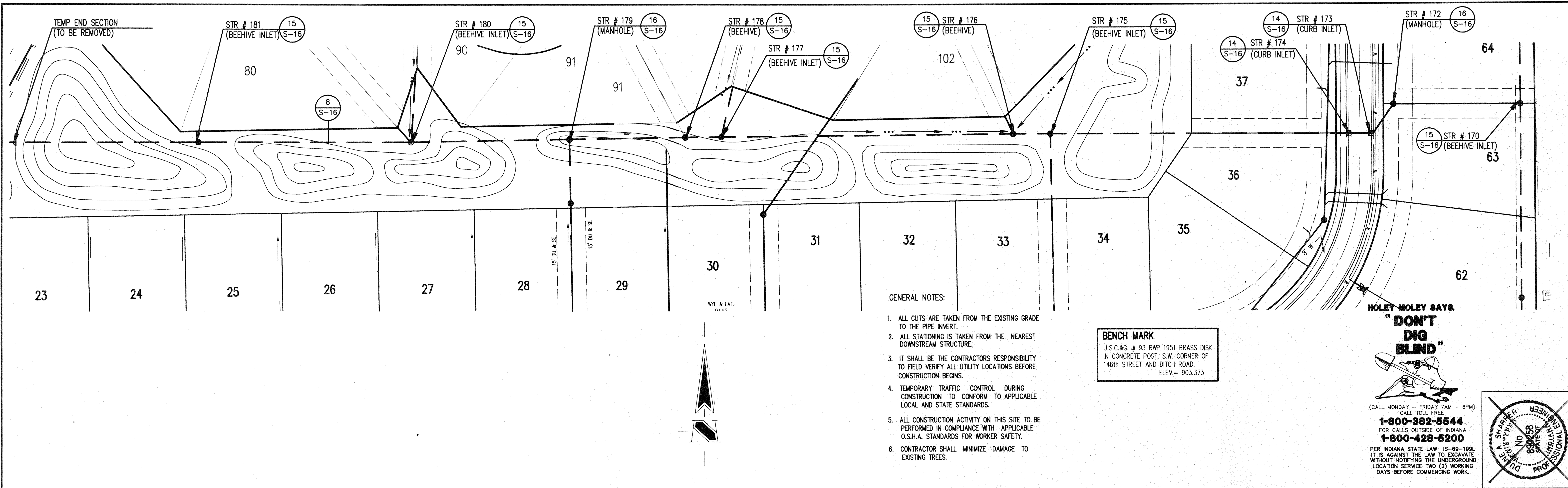

STORM SEWER PLAN

SCALE: 1"=50'

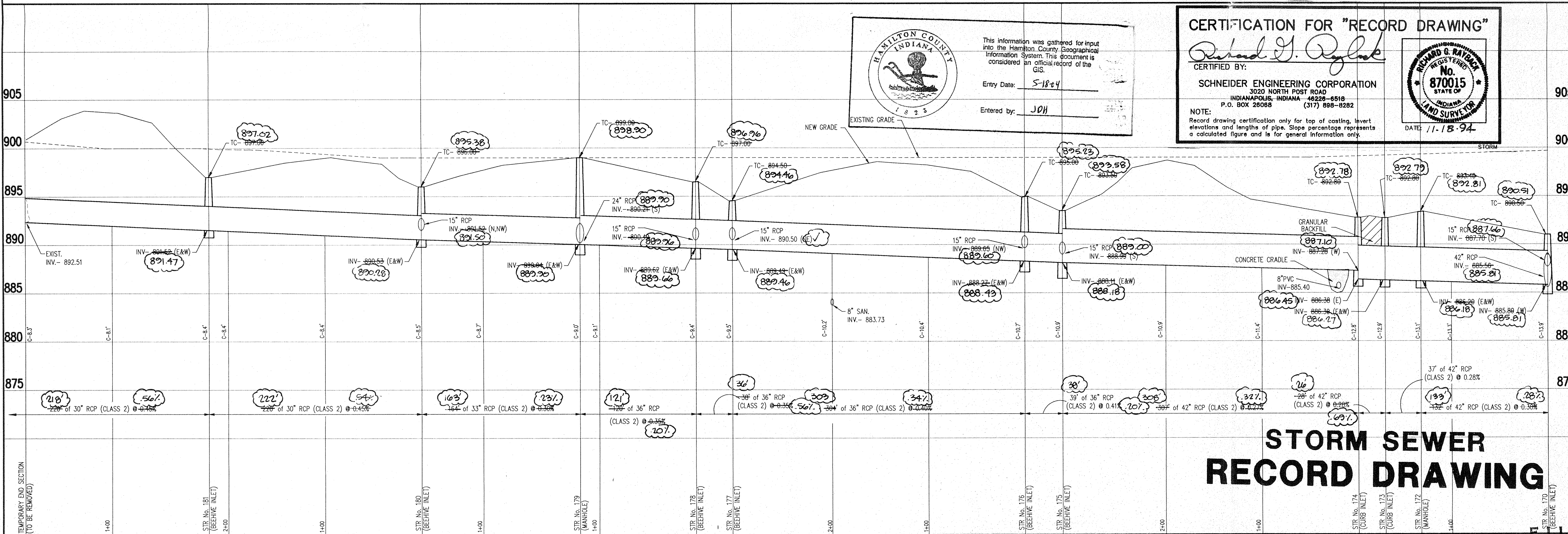

STORM SEWER PROFILE

SCALE: HORZ.: 1"=50' VERT.: 1"=5'
 DEC 1 1994
 OFFICE OF HAMILTON COUNTY SURVEYOR 18

REVISIONS

NO.	DATE	CHECKED BY	DATE	CHECKED BY
1	12/1/94	MD	12/1/94	MD

DRAWN BY MD
DATE 12/1/94
CHECKED BY MD
DATE 12/1/94
ISSUED BY MD
DATE 12/1/94

SCHNEIDER ENGINEERING CORPORATION
 Professional Engineers • Land Planners • Geologists
 Land Surveyors • Geotechnical Engineers
 3020 NORTH POST ROAD
 INDIANAPOLIS, INDIANA 46228-8518
 Telephone: (317) 898-8282
 Fax: (317) 898-8010

THE MEADOWS SECTION 2
 PREPARED FOR BRENNICK DEVELOPMENT CO., INC.
 TITLE: STORM SEWER PLAN & PROFILE

SCALE: SHOWN

FILED

RET

DEC 1 1994

OFFICE OF HAMILTON COUNTY SURVEYOR 18

FILE NAME: 8951291

HOLEY MOLEY SAYS.

"DON'T DIG BLIND"



(CALL MONDAY - FRIDAY 7AM - 6PM)
CALL TOLL FREE
1-800-382-5544
FOR CALLS OUTSIDE OF INDIANA
1-800-428-5200
PER INDIANA STATE LAW IS-69-199L
IT IS AGAINST THE LAW TO EXCAVATE
WITHOUT NOTIFYING THE UNDERGROUND
LOCATION SERVICE TWO (2) WORKING
DAYS BEFORE COMMENCING WORK.

BENCH MARK
U.S.C.&G. # 93 RWP 1951 BRASS DISK
IN CONCRETE POST, S.W. CORNER OF
146TH STREET AND DITCH ROAD.
ELEV. = 903.373

- GENERAL NOTES:
- ALL CUTS ARE TAKEN FROM THE EXISTING GRADE TO THE PIPE INVERT.
 - ALL STATIONING IS TAKEN FROM THE NEAREST DOWNSTREAM STRUCTURE.
 - IT SHALL BE THE CONTRACTORS RESPONSIBILITY TO FIELD VERIFY ALL UTILITY LOCATIONS BEFORE CONSTRUCTION BEGINS.
 - TEMPORARY TRAFFIC CONTROL DURING CONSTRUCTION TO CONFORM TO APPLICABLE LOCAL AND STATE STANDARDS.
 - ALL CONSTRUCTION ACTIVITY ON THIS SITE TO BE PERFORMED IN COMPLIANCE WITH APPLICABLE O.S.H.A. STANDARDS FOR WORKER SAFETY.
 - CONTRACTOR SHALL MINIMIZE DAMAGE TO EXISTING TREES.

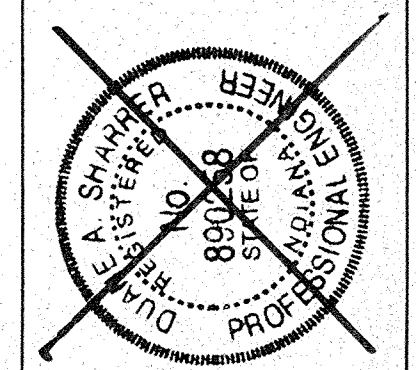

REVISIONS

NO.	DATE	CHECKED BY	DATE	CHECKED BY
1	11/18/94	MM	11/18/94	MM
2				
3				

Richard G. Raveck
CERTIFIED

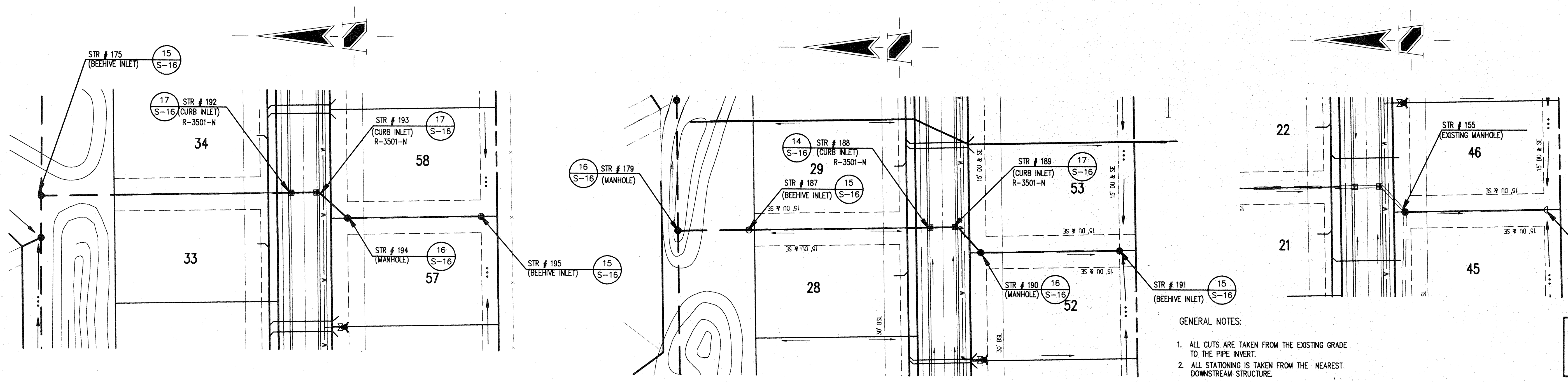

STORM SEWER PLAN

SCALE: 1"=50'

CERTIFICATION FOR "RECORD DRAWING"

CERTIFIED BY: *Richard G. Raveck*

SCHNEIDER ENGINEERING CORPORATION
3020 NORTH POST ROAD
INDIANAPOLIS, INDIANA 46226-8516
P.O. BOX 28068 (317) 898-8282

NOTE: Record drawing certification only for top of coating, invert elevations and lengths of pipe. Slope percentage represents a calculated figure and is for general information only.

DATE: 11-18-94

RICHARD G. RAVECK
No. 870015
STATE OF INDIANA
LAND SURVEYOR

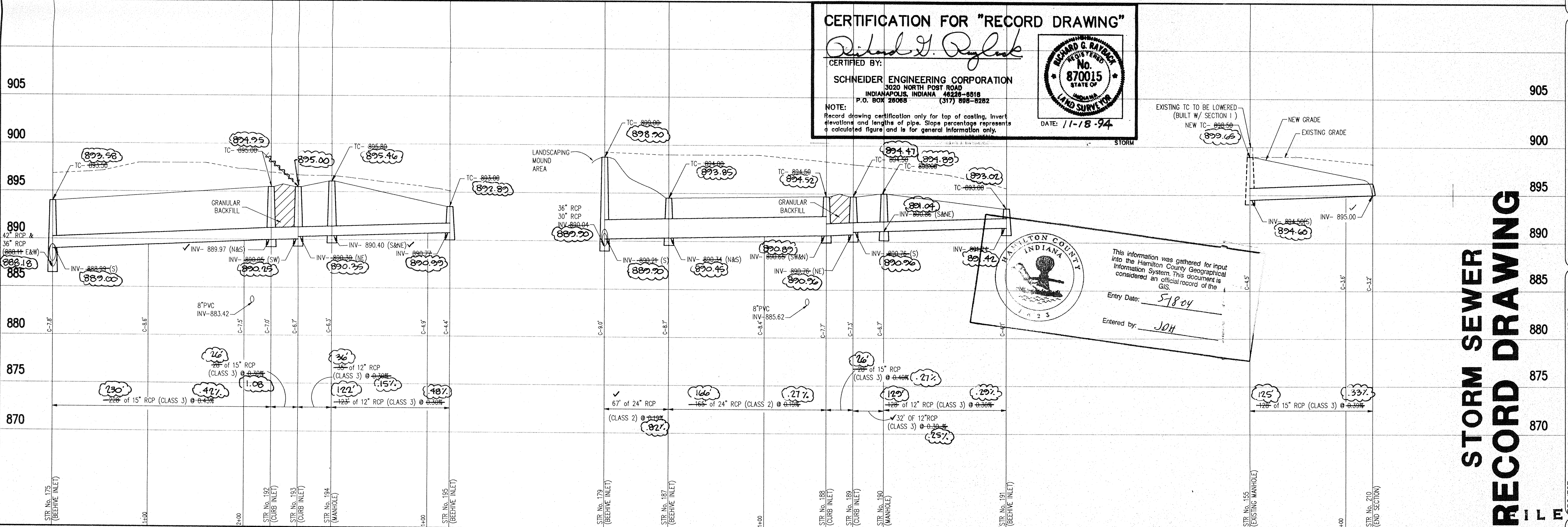

STORM SEWER RECORD DRAWING

This information was gathered for input into the Hamilton County Geographical Information System. This document is considered an official record of the GIS.

Entry Date: 5/18/04
Entered by: J04

SCHNEIDER ENGINEERING CORPORATION
Professional Engineers • Land Planners
Land Surveyors • Geologists
3020 NORTH POST ROAD
INDIANAPOLIS, INDIANA 46226-8516
Telephone: (317) 898-8282
Fax: (317) 899-8010

PROJECT: THE MEADOWS SECTION 2
JOB NO.: 895.12
PREPARED FOR: BRENNICK DEVELOPMENT CO., INC.
TITLE: STORM SEWER PLAN & PROFILE
SCALE: SHOW

STORM SEWER PROFILE

SCALE: HORZ.: 1"=50' VERT.: 1"=5'

This copy printed from the Digital Archive of the Hamilton County Surveyor's Office, One Hamilton Co. Square, Ste. 188, Noblesville, IN 46060

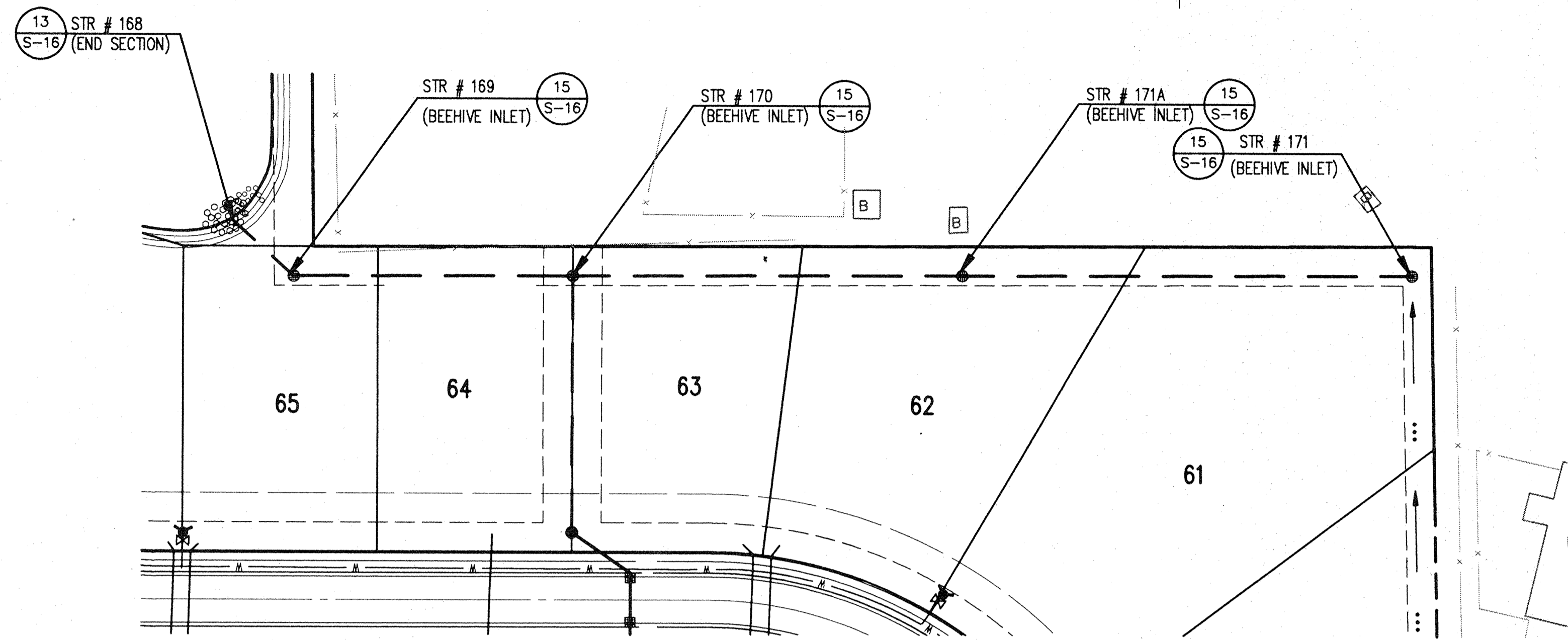

THE CROSSINGS AT
SPRINGMILL VILLAGES
SECTION 2

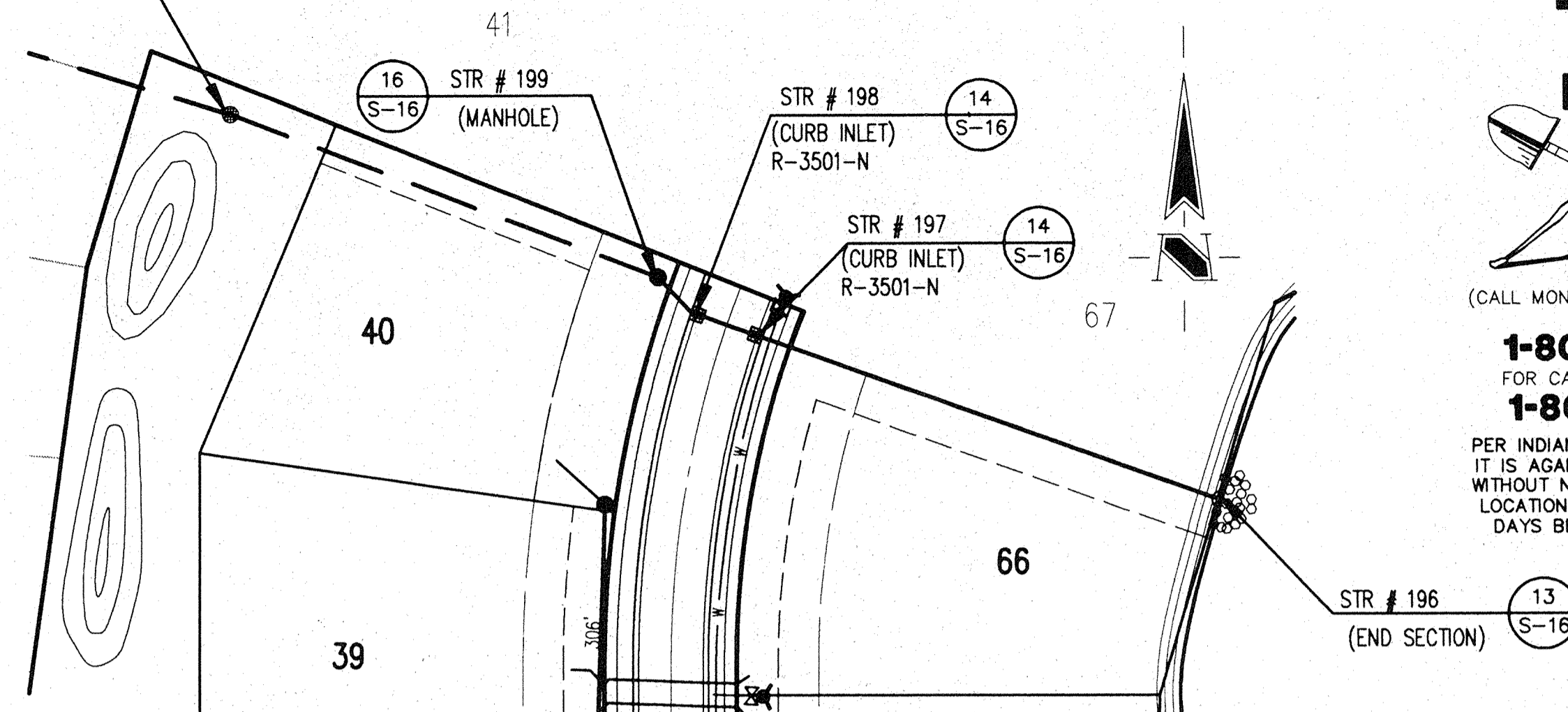

**HOLEY MOLEY SAYS,
"DON'T
DIG
BLIND"**

(CALL MONDAY - FRIDAY 7AM - 6PM)
CALL TOLL FREE
1-800-382-5644
FOR CALLS OUTSIDE OF INDIANA
1-800-428-5200

PER INDIANA STATE LAW IS-69-199L
IT IS AGAINST THE LAW TO EXCAVATE
WITHOUT NOTIFYING THE UNDERGROUND
LOCATION SERVICE TWO (2) WORKING
DAYS BEFORE COMMENCING WORK.

GENERAL NOTES:

1. ALL CUTS ARE TAKEN FROM THE EXISTING GRADE TO THE PIPE INVERT.
2. ALL STATIONING IS TAKEN FROM THE NEAREST DOWNSTREAM STRUCTURE.
3. IT SHALL BE THE CONTRACTORS RESPONSIBILITY TO FIELD VERIFY ALL UTILITY LOCATIONS BEFORE CONSTRUCTION BEGINS.
4. TEMPORARY TRAFFIC CONTROL DURING CONSTRUCTION TO CONFORM TO APPLICABLE LOCAL AND STATE STANDARDS.
5. ALL CONSTRUCTION ACTIVITY ON THIS SITE TO BE PERFORMED IN COMPLIANCE WITH APPLICABLE O.S.H.A. STANDARDS FOR WORKER SAFETY.
6. CONTRACTOR SHALL MINIMIZE DAMAGE TO EXISTING TREES.

BENCH MARK

U.S.C.A.G. # 93 RWP 1951 BRASS DISK
IN CONCRETE POST, S.W. CORNER OF
146th STREET AND DITCH ROAD.
ELEV. = 903.373

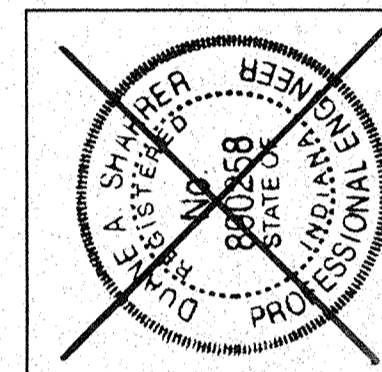

REVISIONS	DATE	CHECK	BY

STORM SEWER PLAN

SCALE: 1" = 50'

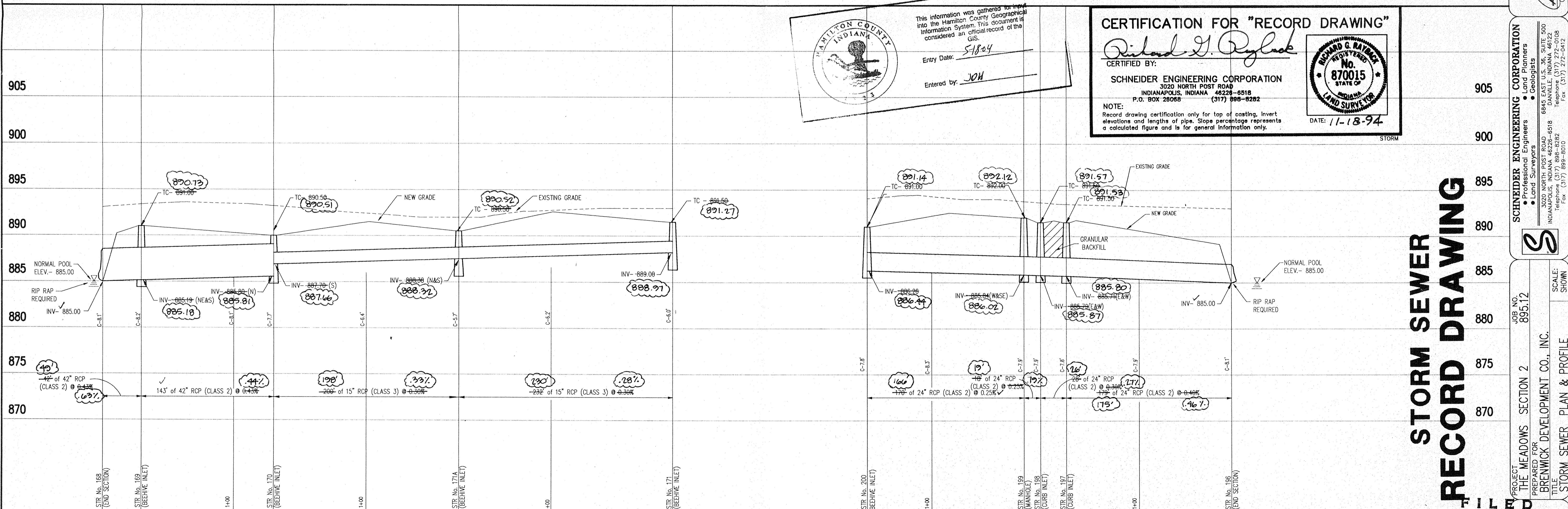

This information was gathered for input into the Hamilton County Geographical Information System. This document is considered an official record of the GIS.

Entry Date: 5-18-94
Entered by: JON

CERTIFICATION FOR "RECORD DRAWING"

Richard G. Raveck
CERTIFIED BY:

SCHNEIDER ENGINEERING CORPORATION
3020 NORTH POST ROAD
INDIANAPOLIS, INDIANA 46226-6518
P.O. BOX 28068 (317) 998-8282

NOTE:
Record drawing certification only for top of casting, invert elevations and lengths of pipe. Slope percentage represents a calculated figure and is for general information only.

DATE: 11-18-94

STORM SEWER RECORD DRAWING

PROJECT: THE MEADOWS SECTION 2
PREPARED FOR: BRENNICK DEVELOPMENT CO., INC.
TITLE: STORM SEWER PLAN & PROFILE

JOB NO. 895.12
SHEET S-12

STORM SEWER PROFILE

SCALE: HORZ.: 1" = 50'
VERT.: 1" = 5'

DEC 1 1994
OFFICE OF HAMILTON COUNTY SURVEYOR